

HX 300 PANORAMA



Frameless appearance and technologically optimised construction connection

PROPERTIES



Thermal insulation U_w as low as 0.76 W/(m²K)



Sound reduction Up to 43 dB



I-tec Glazing

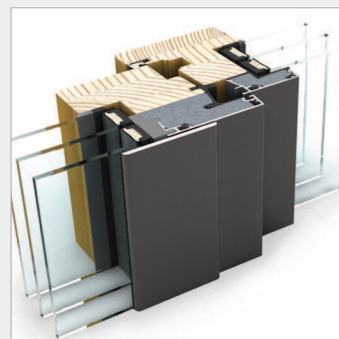
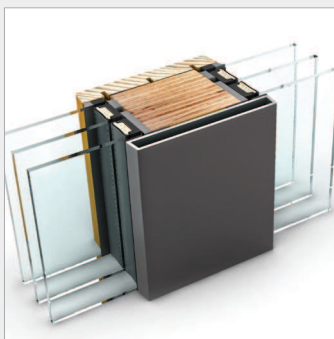

HX 300

Trendy, narrow glass joints facilitate discreet transitions of large glass areas.

A glass-dividing mullion can be installed to provide the required static for even larger glazings. Upon request, all Internorm timber/aluminium windows (one or two-sash) can be integrated in HX 300.

Sections

Vertical

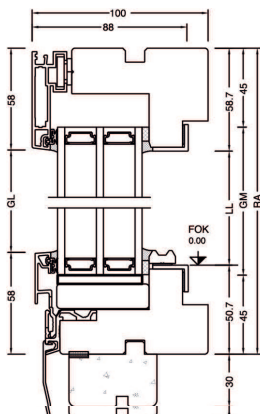

Horizontal

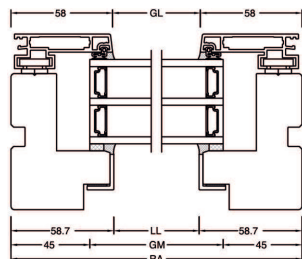

Horizontal with installed window

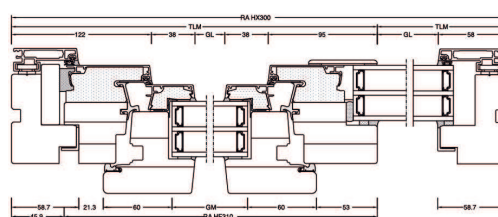

Vertical with
installed window

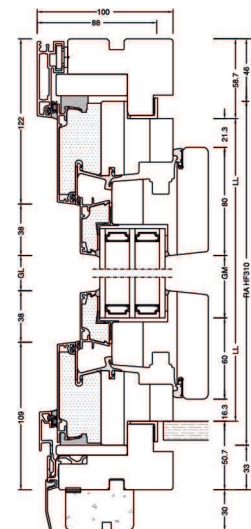

Technical information/designs

- Max. RA 4000 x 2800 mm
- Aluminium profiles mitred and caulked with UPVC and aluminium brackets
- Anodised, RAL, highly weather-resistant structure, metallic and timber decor colours available in aluminium outside
- Glass thicknesses 28, 48, 54 mm
- Glass panes sealed with silicone all round inside and outside
- One-part fixed frame glazing
- Installation of vertical mullion or glass joint available
- Installation of window/door models available

Values

Glass buildup	GC	Spacer	Coating	Ug	g	Uf	Psi	Uw	Thermal certif.	Rw	C	Ctr	Sound certif.
4b/18Ar/4/18Ar/b4	3N2	Iso	ECLAZ	0.5	60%	1.33	0.039	0.74	YES	35	-2	-5	YES
4bESG/18Ar/4/18Ar/b4ESG	3T6	Iso	ECLAZ	0.5	59%	1.33	0.039	0.74*	NO	35*	-2	-5	NO
6bESG/18Ar/6ESG/18Ar/b6ESG	3FD	Iso	ECLAZ	0.5	57%	1.33	0.039	0.74	YES	37	-2	-6	YES
6bESG/16Ar/b6ESG	2UF	Iso	ECLAZ	1.1	69%	1.55	0.052	1.3	YES	34	-1	-3	YES
44b.2(VSG-S)/ 15Ar/4/12Ar/ b44.2(VSG-S)	3FH	Iso	ECLAZ	0.7	55%	1.33	0.051	0.94	YES	47	-1	-3	YES

ECLAZ®

Daylight is crucial for our human organism, our wellbeing and our health. Therefore, Internorm windows are equipped with premium glass coating ECLAZ® as standard. The blue components of the light spectrum are transported through the glass more and ensure up to 10 % more daylight. Compared to conventional market glazing, ECLAZ® is offering:

- | | | | |
|--------------------------|---|--|--|
| More aesthetics – | colour-neutral outside view, a combination of function and aesthetics | Room comfort – | makes living areas even lighter and friendlier |
| More light – | up to 10% more daylight – better for health and wellbeing – a significant advantage especially in the dark winter months* | Energy efficiency – | excellent insulation of interior thus reducing heating costs - increased energy efficiency in building - up to 11 % less CO ₂ emissions |
| Visual comfort – | for a brilliant view to the outside | * In direct comparison to same glass buildups. | |

* In direct comparison to same glass buildups.